

FAG Wheelset Bearings in the High-Power Locomotive “TAURUS”



Examples of Application Engineering

Publ. No. WL 07 510 EA



High-power locomotive “TAURUS” of series Rh1016/1116: Developed and built by Siemens AG, Austria in cooperation with Krauss-Maffei Verkehrstechnik GmbH, München-Allach

Courtesy: Krauss-Maffei

Single- and double-system versions of the electric locomotive TAURUS are built:

Rh1016 (single-frequency version for 1~ 16.7 Hz, 15 kV) and Rh1116

(dual-frequency version additional for 1~ 50 Hz, 25 kV).

The Austrian railway company Österreichische Bundesbahn (ÖBB) ordered 75 locomotives from Sie-

mens AG Austria, with an option for an additional 325 locomotives, 100 of which were already ordered.

The wheelset bearings are supplied by FAG OEM/Distribution.

A Member of the
Schaeffler Group

Bogie and wheelsets

The bogie design makes an easy, passive radial adjustment of the wheelsets possible. In addition, the disk brake and the traction motor are located in the fully suspended part of the drive block and can be removed without dismantling wheelset and drive.



Courtesy: Krauss-Maffei

Vehicle Data

Max. speed in operation	230 km/h
Drive power	6400 kW
Axle load	21.5 t
Wheelset weight	2.4 t
Maintenance interval	1 million km

Wheelset bearings

- Cartridge-type unit with cylindrical roller bearings
- Dimensions: 160 x 270 x 170 mm
- Non-rubbing sheet metal seals
- No relubrication during operation
- Nondestructive testing of bearing components

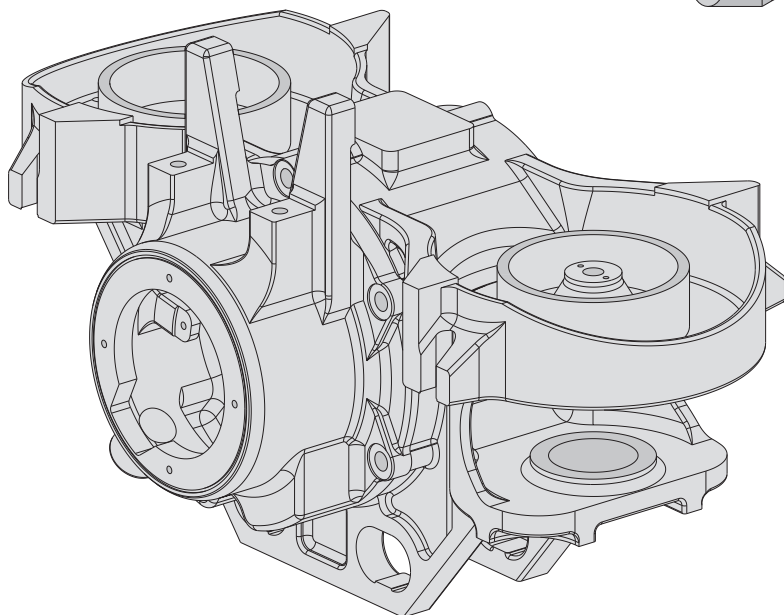
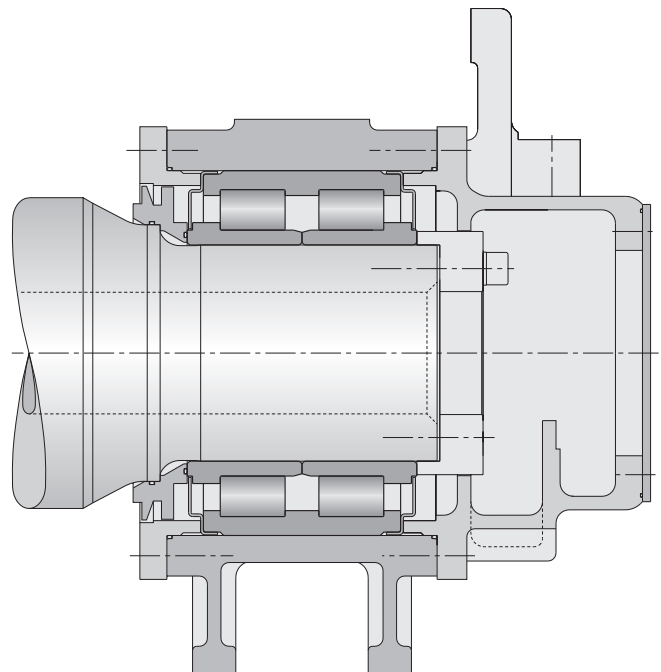

FAG Kugelfischer AG
Product line Railway
Postfach 1260
D-97419 Schweinfurt
Tel.: +49 9721 913978
Fax: +49 9721 913788
E-mail: rail_transport@fag.de
www.fag.com