

# Needle roller bearings with TWin Cage

## Features

Needle roller bearings with TWin Cage comprise a plastic cage with two adjacent needle rollers per pocket and a machined outer ring, *Figure 1*.



*Figure 1*  
Needle roller bearings  
with TWin Cage



The needle roller bearings are X-life bearings and have raceways with an optimised surface. This gives higher load carrying capacity and longer rating life.

## Advantages

In comparison with conventional needle roller bearings, the friction is reduced by up to 25%:

- difference in frictional energy of up to 35 W at 4 000 min<sup>-1</sup>, compared with a standard bearing NK45/20-TV-XL, *Figure 2*
- reduced heat generation
- longer grease operating life and longer lubrication intervals
- higher accuracy due to smaller temperature differences.

$M_r$  = frictional torque  
 $F$  = bearing load

① Standard bearing  
with one needle roller per pocket  
(suffix TV)

② TWin Cage

*Figure 2*  
Lower friction  
in needle roller bearings  
with TWin Cage

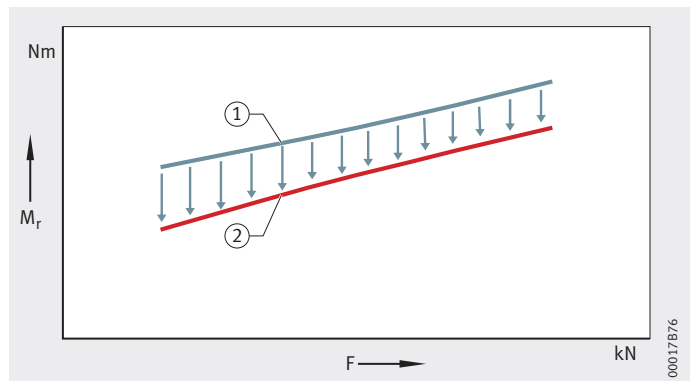

## Operating temperature

Open bearings can be used at operating temperatures from -20 °C to +120 °C.

## Suffixes

Suffixes for available designs: see table.

## Available designs

Suffix	Description	Design
TW	Bearing with cage made from glass fibre reinforced polyamide 66 and two short needle rollers per cage pocket	Standard

# Needle roller bearings

Without inner ring  
With inner ring  
Open

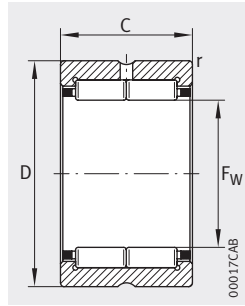

NK...TW

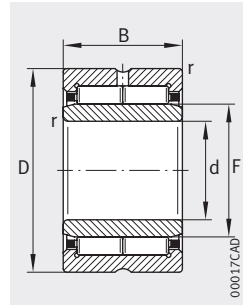

NKI...TW

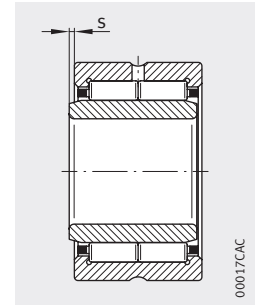

Axial displacement

**Dimension table** · Dimensions in mm

Designation	Mass m ≈ g	Dimensions						Basic load ratings		Fatigue limit load C <sub>ur</sub> N	Limiting speed n <sub>G</sub> min <sup>-1</sup>	Reference speed n <sub>B</sub> min <sup>-1</sup>	Availability from 2011
		d	F <sub>w</sub>	D	C	r min.	s	dyn. C <sub>r</sub> N	stat. C <sub>0r</sub> N				
<b>NK30/20-TW-XL</b>	61	–	30	40	20	0,3	–	28 000	39 000	7 300	14 800	7 800	2nd quarter
<b>NKI35/20-TW-XL</b>	122	35	40	50	20	0,3	0,5	33 500	53 000	9 900	11 400	6 300	2nd quarter
<b>NKI40/30-TW-XL</b>	216	40	45	55	30	0,3	1	52 000	102 000	18 200	10 200	5 500	3rd quarter
<b>NKI55/25-TW-XL</b>	255	55	60	72	25	0,6	1,5	53 000	98 000	17 000	7 700	4 450	2nd quarter

## Schaeffler Technologies GmbH & Co. KG

Industriestraße 1–3  
91074 Herzogenaurach (Germany)  
Internet [www.ina.com](http://www.ina.com)  
E-Mail [info@schaeffler.com](mailto:info@schaeffler.com)

In Germany:

Phone 0180 5003872  
Fax 0180 5003873

From other countries:

Phone +49 9132 82-0  
Fax +49 9132 82-4950

Every care has been taken to ensure the correctness of the information contained in this publication but no liability can be accepted for any errors or omissions. We reserve the right to make technical changes.

© Schaeffler Technologies GmbH & Co. KG  
Issued: 2011, March

This publication or parts thereof may not be reproduced without our permission.

PDB 23 GB-D