

Engine  
Chassis  
**Transmission**  
E-Mobility

**SCHAEFFLER**

# Compact Actuator for E-Clutches

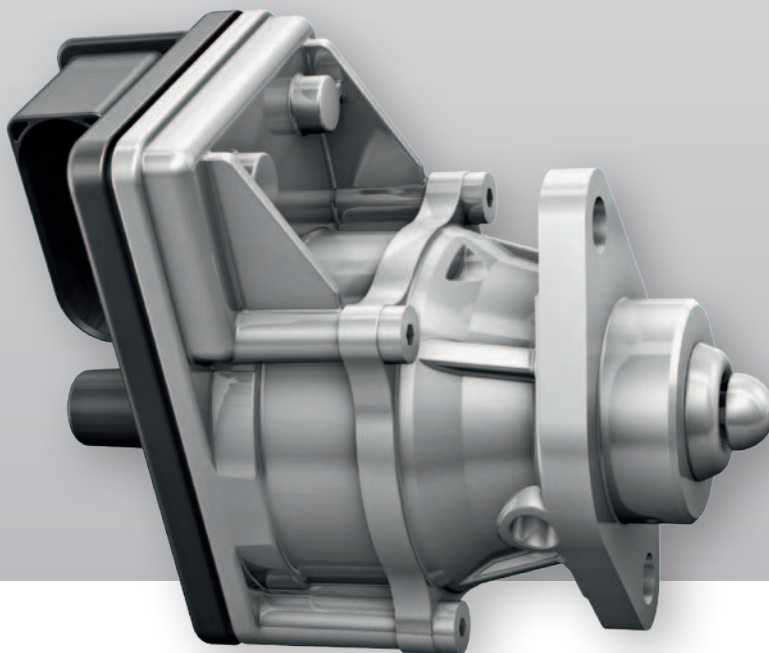

# Compact Actuator for E-Clutches

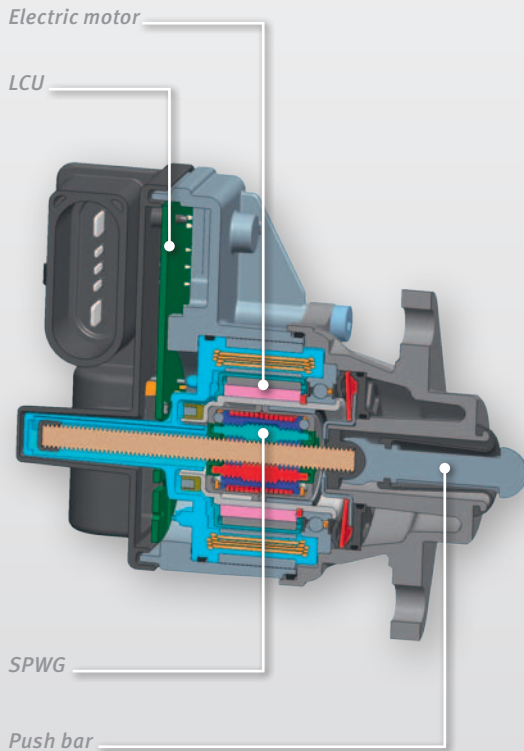

## Description

- Compact electromechanical clutch actuator

## Functional advantages

- Low power consumption
- Improved dynamics
- Local control unit (LCU) with torque interface (CAN), UBATT wake-up

## Product benefits

- Fuel saving due to engine start-stop strategies (sailing)
- Assisted starting (smooth starting and gearshifts)
- Engine stall protection
- Stop-and-go assistant (creeping)
- Clutch-independent pedal characteristic

## Integration/installation

- Simple add-on system for manual transmissions
- Compact design (dimensions: 60×90×120 mm, weight 0.9 kg)
- Purely mechanical system
- Integrated LCU