

FAG Wheelset Bearings in the „Herkules“ Diesel Electric Locomotive



Examples from Application Engineering

Publ. No. WL 07 520 EA



„HERKULES“ Rh2016 series diesel electric locomotive, developed and built in cooperation by Siemens SGP (Graz) and Siemens Krauss-Maffei Lokomotiven GmbH, Munich-Allach

Courtesy of Siemens Krauss-Maffei Lokomotiven GmbH

The Rh2016 „HERKULES“ is a general purpose diesel electric locomotive used for both goods and passenger transport.

The order for Siemens SGP Graz from Austrian Railways (ÖBB) covers 70 locomotives with an option of another 80 units.

The power of each locomotive is 1600 kW per axle.
The scope of delivery for FAG Kugelfischer Georg Schäfer AG comprises all wheelset bearings.

Vehicle data

Top speed	140 km/h
Diesel motor power	2 000 kW
Axle arrangement	Bo´Bo´
Length	19 275 mm
Starting traction capacity	235 kN
Axle load	20 t
Total gross load	80 t
Maintenance interval	1 million km

Bogie and wheelsets

Like with the „TAURUS“ heavy haul locomotive, the bogie design enables an easy passive radial adjustment of the wheelsets.

The bogies feature wheel mounted disk brakes and a pinion-and hollow shaft drive. The tractive force is transmitted via truck pins.



Courtesy of Siemens AG Transportation Systems

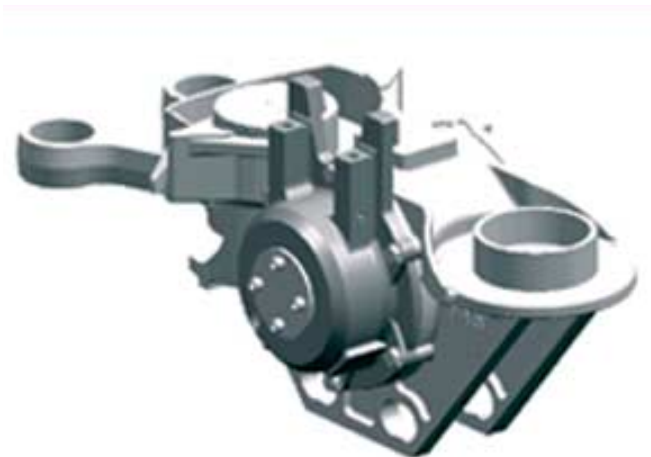

Courtesy of Siemens AG Transportation Systems

Wheelset bearing

- Cartridge type unit with ASZ160Z.176236.- cylindrical roller bearings
- Bearing dimensions: $\varnothing 160 \times 270 \times 170$ mm
- Non rubbing sheet metal seals
- No relubrication required during operation
- Non destructive testing of bearing components

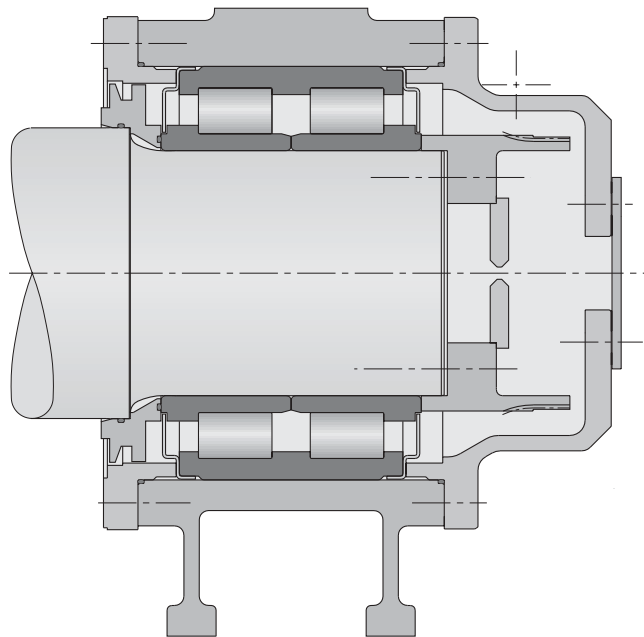

FAG Kugelfischer Georg Schäfer AG

Industrial Bearings and Services

Railway & Transport

Phone: +49 9721 91-3136

Fax: +49 9721 91-3788

e-mail: rail_transport@fag.de

Internet: www.fag.com